

Top of Tank Line, Plastics

Type: 25272/2.5 PP

Design meets the requirements of PED 2014/68/EU and harmonized standards

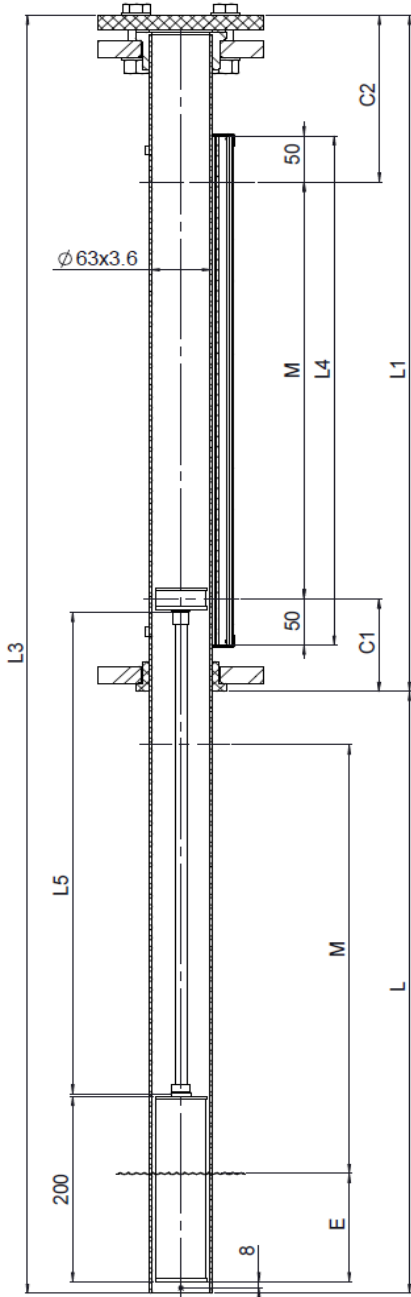

Purchase Order Data

Company: Project:
 Purchase order No.:
 Quantity: Tag No.:

Operating Conditions

Fluid:
 Density: $\geq 0.65\text{g/cm}^3$ @ L5=500 g/cm3:
 Viscosity: $\leq 600\text{cSt}$ cSt:
 Operation pressure: max. 2.5bar(g)@20°C *1) bar(g):
 Design pressure: " bar(g):
 Operation temperature: -10°C ... +80°C *1) °C:
 Design temperature: " °C:
 Gaskets for top service connection: FKM

Process Connections

Connection dimension acc. EN1092 : 2013

- EN1092-1/02 A/DN50/PN16/PP-V
- Collar bushing, sealing surface grooved

Connection dimension acc. ASME B16.5:2013

- ANSI/ASME B16.5/2" class150/PP-V
- Collar bushing, sealing surface grooved

Special flange execution

Dimensions

- Tank depth L
- Length L1 (M + 280 mm)
- C1
- C2
- Measuring length M (L - 200 mm)
- Length L4 (M + 100 mm)
- Connection pipe length L5
- Immersion depth E

Standard

L	0
C1	100
C2	180
M	0
L4	0
L5	0
E	-

Special

L	
C1	
C2	
M	0
L4	0
L5	0
E	-

Design and Materials

Float chamber: PP

Float:

Magnet holder:

Indication Rail

PC, IP65 (<150°C)	Flaps: red-silver	No.: 34837	Standard	<input type="checkbox"/>
PC, IP68, inert gas (<150°C)	Flaps: red-silver	No.: 41008		<input type="checkbox"/>
Al/PC, IP54 (<250°C)	Flaps: red-silver	No.: 34560		<input type="checkbox"/>
Al/Glass, IP54 (<400°C)	Flaps: black-silver	No.: 37100		<input type="checkbox"/>
316L, IP67 (<250°C)	Flaps: red-silver	No.: 42403		<input type="checkbox"/>
316L, IP67 (<400°C)	Flaps: black-silver	No.: 42404		<input type="checkbox"/>
Special execution	Flaps: <input type="text"/>	No.: <input type="text"/>		<input type="checkbox"/>

Float Extension bottom / top

	C1:	C2:
Standard	100	180

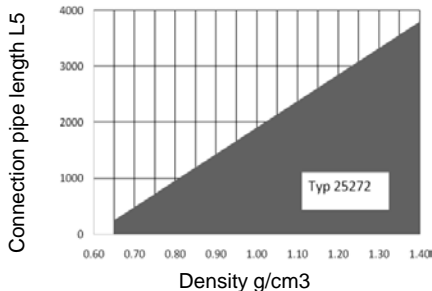

Accessories (refer to installation instructions 20010501)

Reinforcement pipe D68x1.5mm:
 Fixation bracket No. 26936:
 Magnetic switch: Quantity: Dim. "A" [mm]:
 Transmitter: Resolution [mm]: Type:
 Electrical measuring length Mel [mm]:
 Converter: Type:
 Additional accessories:

Special Executions & Additional Notes

Notes

- *1) Refer to pressure-temperature rating! Lowest rating of any connecting flange or fitting and float chamber sets the limitation. The test pressure PT is specified acc. to WEKA specifications AW 2.1.2.

All mentioned dimensions are in mm and are valid only for ToT standard executions.