

**Top of Tank Line, Plastics**

**Type: 25271/10 PVDF**

Design meets the requirements of PED 2014/68/EU and harmonized standards

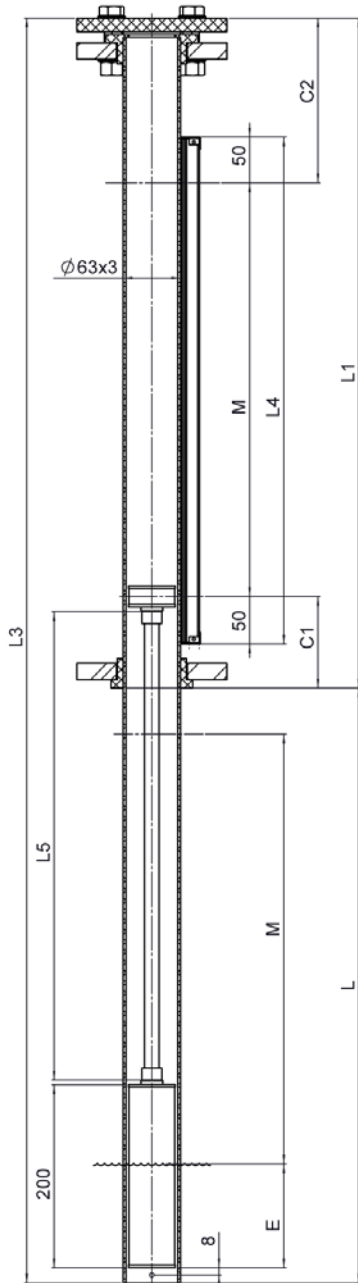

**Purchase Order Data**

Company:  
Purchase order No.:  
Quantity:

Project: \_\_\_\_\_  
Tag No.: \_\_\_\_\_

**Operating Conditions**

Fluid:  
Density:  $\geq 0.87\text{g/cm}^3$  @ L5=500  
Viscosity:  $\leq 600\text{cSt}$   
Operation pressure: max. 10bar(g) @20°C \*1  
Design pressure: "  
Operation temperature: -20°C ... +140°C \*1  
Design temperature: "  
Gaskets for top service connection: FKM

g/cm3: \_\_\_\_\_  
cSt: \_\_\_\_\_  
bar(g): \_\_\_\_\_  
bar(g): \_\_\_\_\_  
°C: \_\_\_\_\_  
°C: \_\_\_\_\_

**Process Connections**

**Connection dimension acc. EN1092 : 2013**

- EN1092-1/02 A/DN50/PN16/PP-V (t < 80°C) \_\_\_\_\_
- EN1092-1/02 A/DN50/PN16/316L \_\_\_\_\_
- Collar bushing, sealing surface grooved

**Connection dimension acc. ASME B16.5:2013**

- ANSI/ASME B16.5/2"cl.150/PP-V (t < 80°C) \_\_\_\_\_
- ANSI/ASME B16.5/2"cl.150/316L \_\_\_\_\_
- Collar bushing, sealing surface grooved

**Special flange execution**

\_\_\_\_\_

**Dimensions**

Tank depth L  
Length L1 (M + 280 mm)  
C1  
C2  
Measuring length M (L - 200 mm)  
Length L4 (M + 100 mm)  
Connection pipe length L5  
Immersion depth E

**Standard**

0
100
180
0
0
0
-

**Special**

0
0
0
0
-

\_\_\_\_\_

**Design and Materials**

Float chamber: PVDF

Float: \_\_\_\_\_

Magnet holder: Standard ( 29601 ) \_\_\_\_\_

**Indication Rail**

PC, IP65 (<150°C)	Flaps: red-silver	No.: 34837	Standard
PC, IP68, inert gas (<150°C)	Flaps: red-silver	No.: 41008	
Al/PC, IP54 (<250°C)	Flaps: red-silver	No.: 34560	
Al/Glass, IP54 (<400°C)	Flaps: black-silver	No.: 37100	
316L, IP67 (<250°C)	Flaps: red-silver	No.: 42403	
316L, IP67 (<400°C)	Flaps: black-silver	No.: 42404	
Special execution	Flaps: _____	No.: _____	

**Float Extension bottom / top**

	C1:	C2:
Standard	100	180

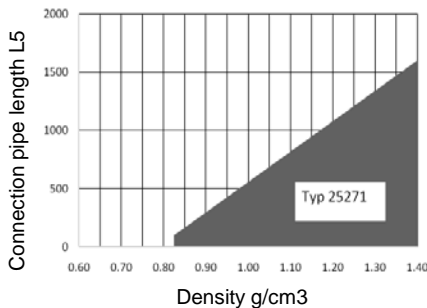

**Accessories (refer to installation instructions 20010501)**

Reinforcement pipe D68x1.5mm: \_\_\_\_\_  
 Fixation bracket No. 26936: \_\_\_\_\_  
 Dim. "A" [mm]: \_\_\_\_\_  
 Magnetic switch: Quantity: \_\_\_\_\_ Type: \_\_\_\_\_  
 Transmitter: Resolution [mm]: \_\_\_\_\_ Type: \_\_\_\_\_  
 Electrical measuring length Mel [mm]: \_\_\_\_\_  
 Converter: Type: \_\_\_\_\_  
 Additional accessories: \_\_\_\_\_

**Special Executions & Additional Notes**

\_\_\_\_\_

**Notes**

\*1) Refer to pressure-temperature rating! Lowest rating of any connecting flange or fitting and float chamber sets the limitation. The test pressure PT is specified acc. to WEKA specifications AW 2.1.2.

All mentioned dimensions are in mm and are valid only for ToT standard executions.